

Richland Township

T24-R2E

DATE: 01/17/2014
Harvey County R & B and GIS

The information contained herein represents that information contained in official records. Any conclusions drawn from such information will be drawn at the sole risk of the user. The use of the data contained herein, and any products derived therefrom, for the purpose of solicitation to buy or sell any product, property or service is strictly prohibited.

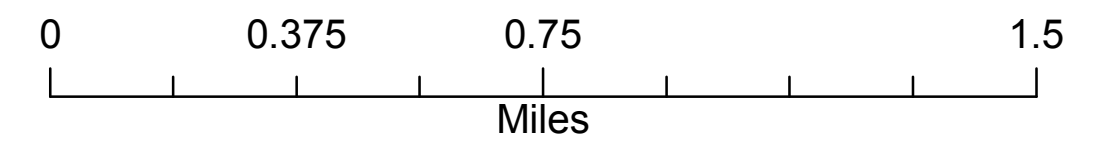

Legend

US Interstate I-135	HV Maintained - Unpaved	Lakes	Landmarks
US Route 50	HV Maintained - Paved/Hard Surface	City Limits	Church
KS Routes	Bridge	Section Number	Cemetery
Paved Road	Railroad Tracks	Townships	Air Capitol Gun Club
Unpaved Road	Rivers, Streams & Creeks	DARLINGTON	
Flood Prone		NEWTON	
Sand Hill Road		PLEASANT	

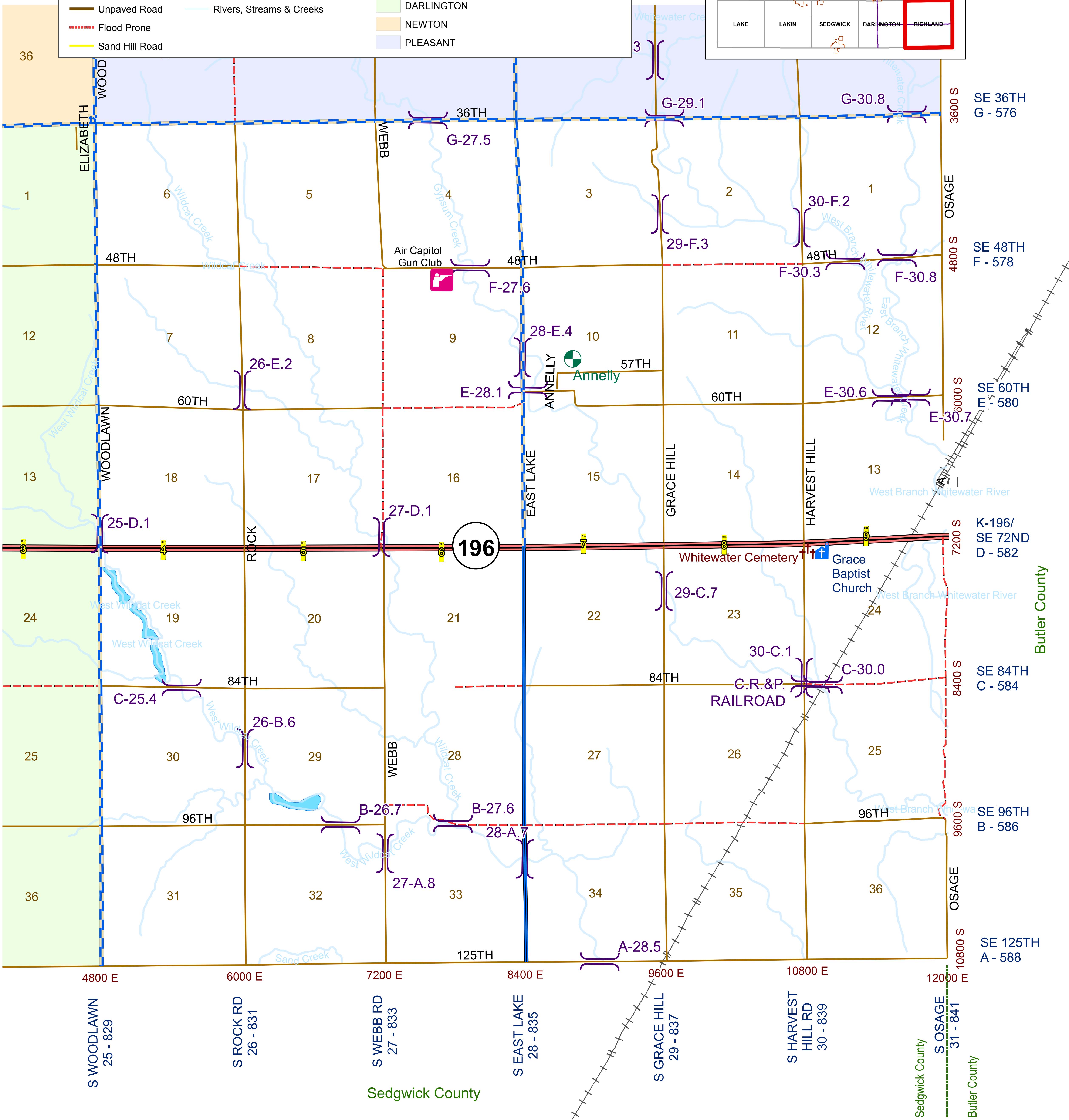
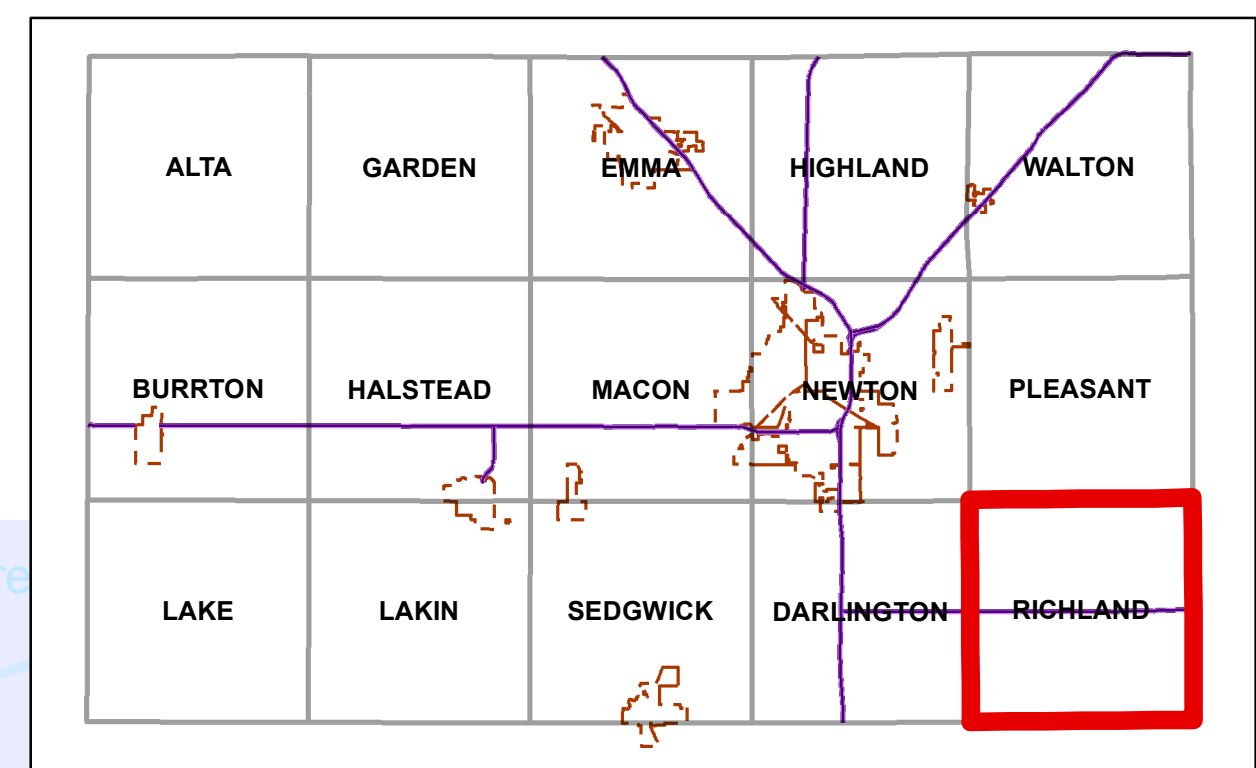

Butler County

Sedgwick County

Sedgwick County

Butler County